

Areas of Expertise

Architectural Programming

Architectural Programming is our core business, and it forms the basis for all the other services we offer. Our approach is to provide superior knowledge and leadership. We work with you to ensure your facility meets the needs we help you to identify.

Facility Programming and Consulting has provided programming services to clients worldwide. Our expertise focuses on all types of clients including corporate, higher education, K-12, laboratories, municipal, and military. Regardless of your need, we can guide you through the investment of programming the right facility up front, which pays big dividends for years to come.

Master Planning

Our master planning process will help you in thoughtfully planning for both short and long-term requirements. Our planning recommendations often include maximizing efficient facilities use, minimizing costs, developing procedures for determining future space needs, and defining requirements. These resulting requirements form the basis for development of a master plan or serve as planning parameters for the primary master planner.

Laboratory Planning and Design

Facility Programming and Consulting offers expertise in both laboratory planning and design. With decades of collective experience, we can manage and implement your project from beginning to end—from initial feasibility through construction.

Our expert staff has a demonstrated history consulting for all types of laboratories, including pharmaceutical, educational, industrial, biological, and chemical industries. We ensure a thorough understanding of exactly how your laboratory will be used and translate that information into the planning and design process.

Strategic Facilities Planning

One of our primary focuses is to plan strategically for future facility requirements. Rather than simply reacting to immediate demands, we use various programming and planning tools to help you define your goals. Working collaboratively, we determine your facilities needs now and in the future.

Project Definition

Successful projects require an understanding of the context and conditions that surround the project. We lead your key staff

Master Plan Proposal
for
Southwest Foundation for
Biomedical Research

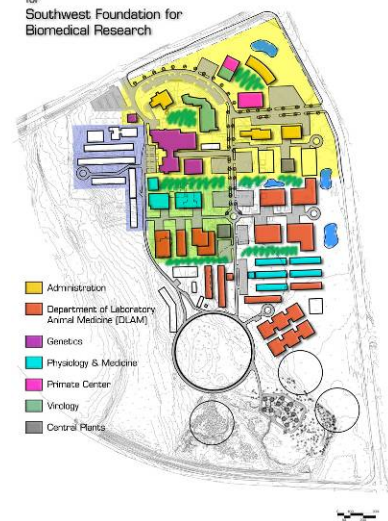

members through a stringent definition process, determining all the criteria that will impact and ultimately define the scope of a project.

We ensure that potentially costly issues are addressed during programming, not waiting until design or construction which typically increases the project cost. Some of these include site location, available utilities, topography, access, relationship to existing facilities, master plan requirements, and code requirements. We examine every detail to make sure we understand your needs exactly. You can count on a thorough definition of your project.

Space Utilization Analysis

Often the most cost effective way for our clients to meet growing demand for space is to measure the effectiveness with which space is used. Space utilization analysis is the process of providing analytical tools to determine space requirements and measure the viability of existing or proposed alternatives.

We use sophisticated computer modeling techniques to analyze your current and proposed space. These models are used to measure your space against benchmarks and other standards. This master planning inside the building technique allows us to help you regulate requirements and illustrate options.

Needs Assessment

Through our extensive experience, we've learned the benefit of analyzing needs for a facility and measuring the success of potential options against specific performance criteria. These criteria can include operational, facility, or financial performance. We provide expertise that enables clients to make smart choices between options such as renovation versus new construction.

Design Criteria

Identifying and documenting design criteria is a critical exercise because it ensures those who build your facilities understand the full scope of a project. Our expertise in this arena is forged from years of experience drafting comprehensive design criteria.

Economic Feasibility and Market Research

Programming is like a three-legged stool. One leg represents the traditional architectural and engineering issues that most firms readily understand. The second leg includes market requirements and opportunities—understanding what is realistic and desirable to current and future stakeholders. The third leg is economic feasibility. At Facility Programming we focus on all three of these pillars—rather than just one or two—providing a balanced perspective for sound business decisions.

